

ALTO DEL MAR NO.  
14-2235-007-0910  
Owner: DONALD J KAHN &  
W LOURDES C  
9538 HARDING

# Harding Avenue Streetscape Improvements

SurfsideGreenway

Harding Avenue Streetscape Improvements

SurfsideGreenway

Presentation

ROSENBERG  
GARDNER  
DESIGN



June 2013 **Stantec**





**Golden Beach**

C3TS/Stantec Project



**Coral Gables**

C3TS/Stantec Project (I.E. Eddie Lamas)



**North Bay Village**

C3TS/Stantec Project



**Surfside**



**Surfside**

**Medjool Date Palms in South Florida**

**Harding Avenue Streetscape Improvements**

*SurfsideGreenway*

Presentation

ROSENBERG  
GARDNER  
DESIGN



**Stantec**



PANEL A

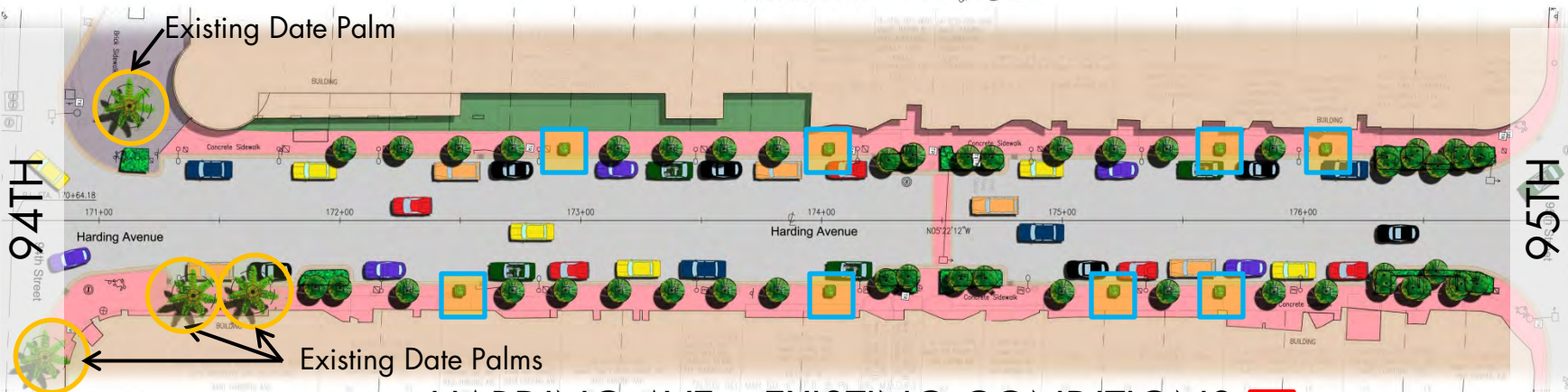

### HARDING AVE – EXISTING CONDITIONS

51 Total Main Palms – Montgomery Palms  
(Main palms not counting intersections and mid-blocks)

18 Total Main Palms Missing  
(Either No Palm or Planter found or shrub in place)

- Missing Planter/Palm
- Existing Shrub No Palm
- Existing Date Palms

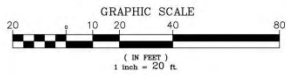

PANEL B

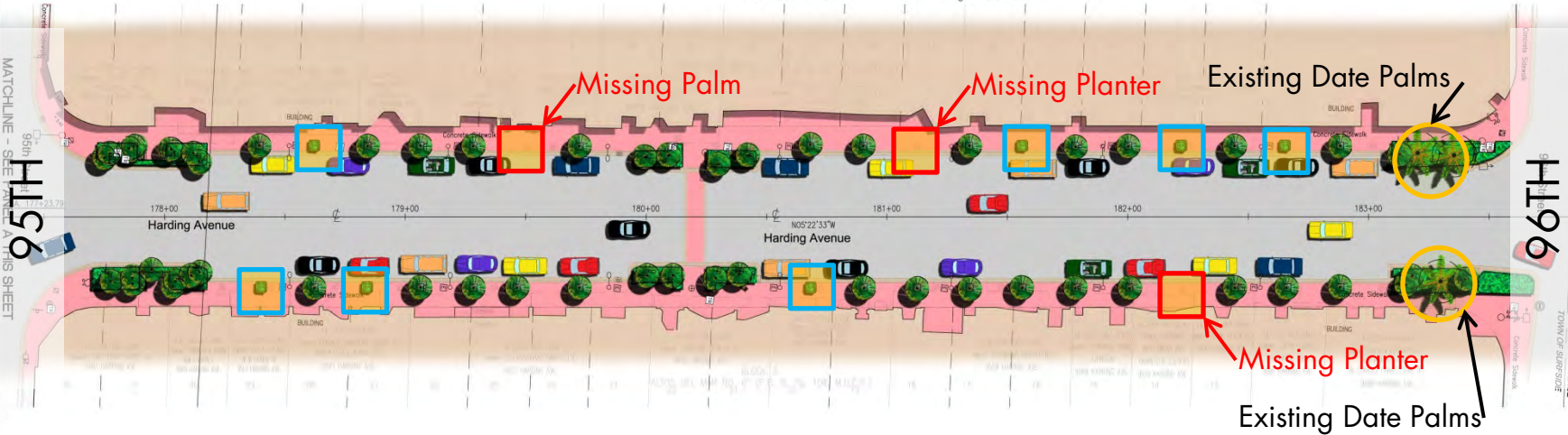

MATCHLINE - SEE PANEL B THIS SHEET

MATCHLINE - SEE PANEL A THIS SHEET



## Harding Avenue Streetscape Improvements

SurfsideGreenway  
Presentation



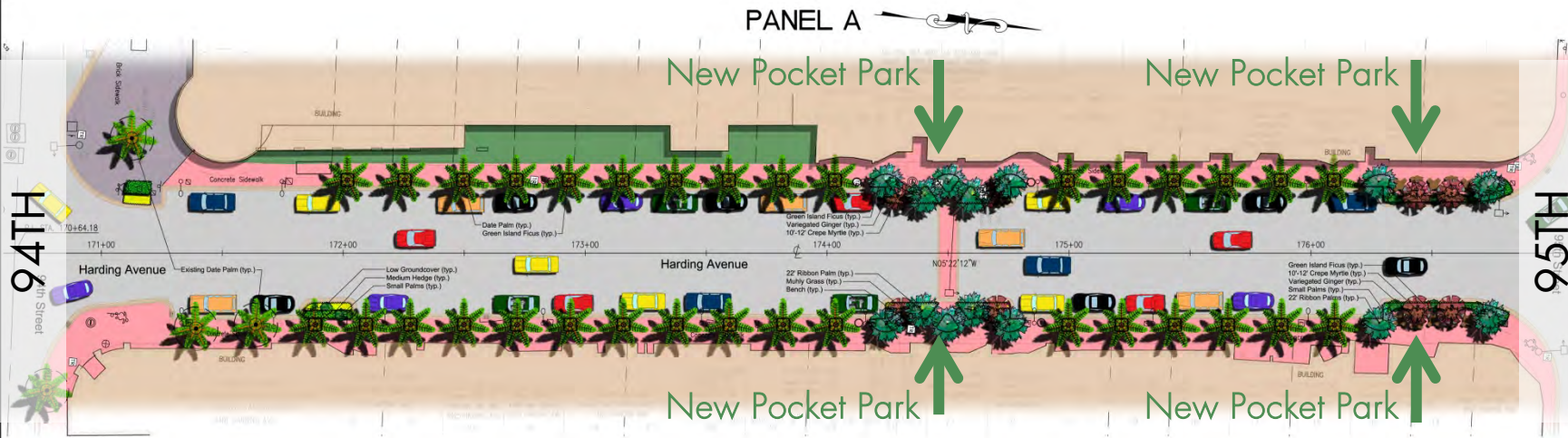

**HARDING AVE – PROPOSED**  
 69 Main Date Palms (18 New Main Date Palms)  
 8 New Pocket Parks

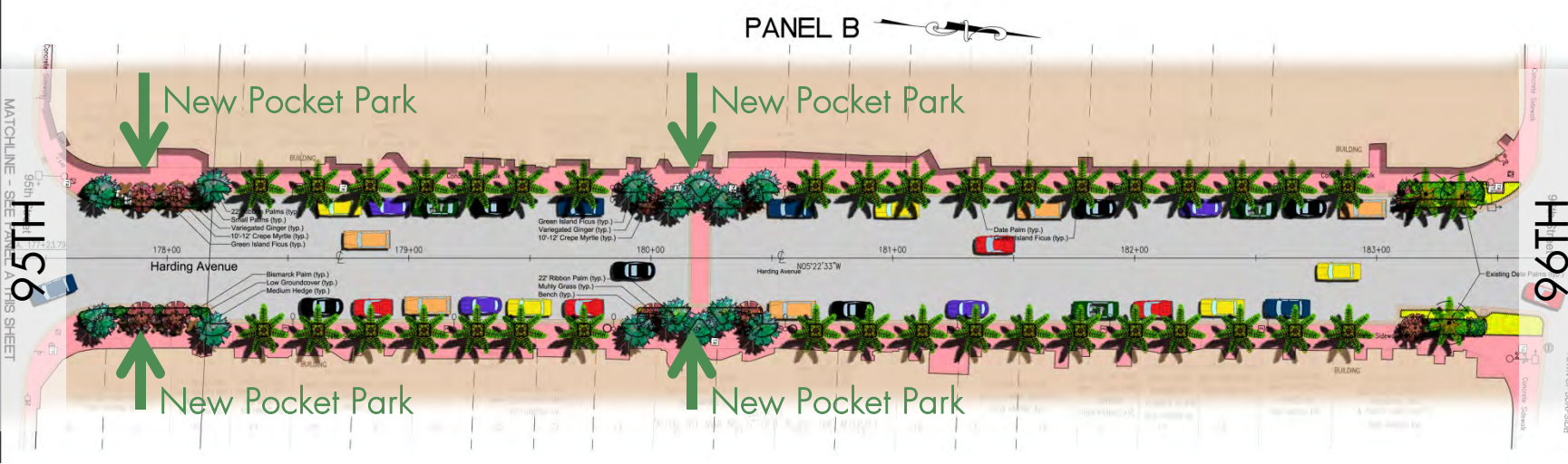

Harding Avenue Streetscape Improvements  
*SurfsideGreenway*  
 Presentation



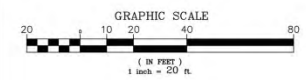
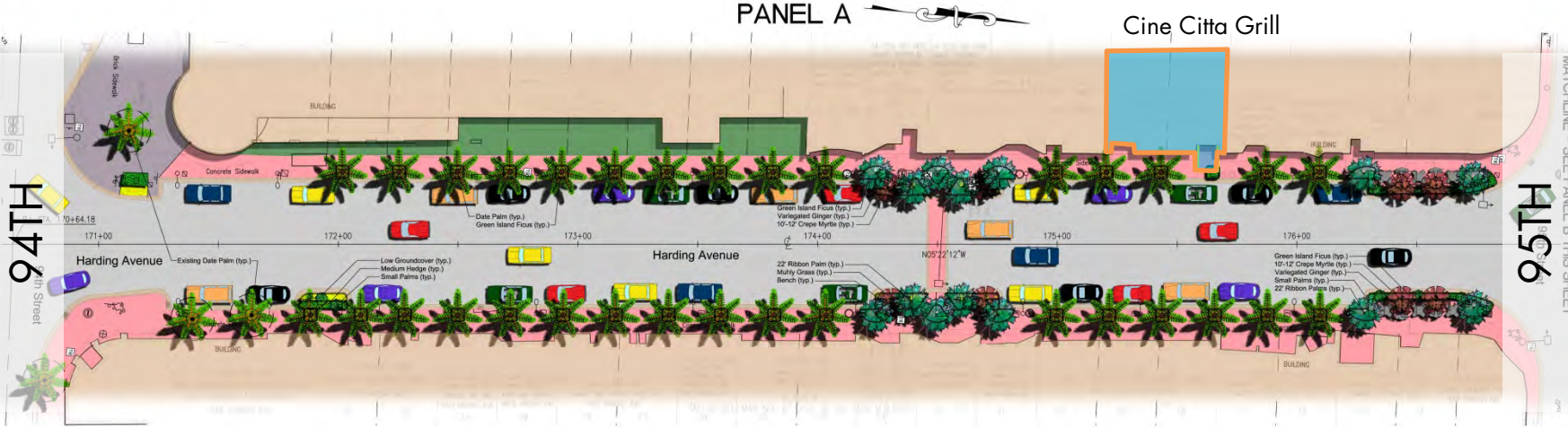

## HARDING AVE – CONFLICTS

(As per updated survey due to original survey discrepancies)  
 In Conflict with 19 New Date Palms – Total without 50 Date Palms

- Resolved Conflict
- Previous Conflict
- Updated Conflict

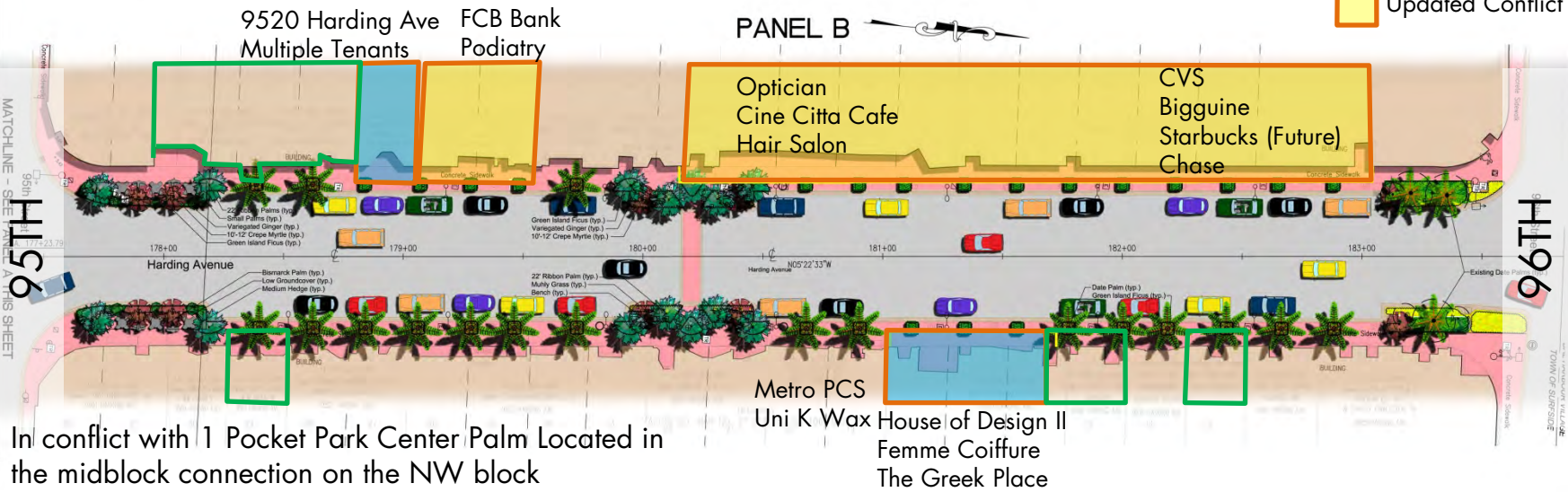

In conflict with 1 Pocket Park Center Palm Located in the midblock connection on the NW block

MATCHLINE - SEE PANEL B THIS SHEET  
 MATCHLINE - SEE PANEL A THIS SHEET  
 TOWN OF SURFSIDE, MIAMI-DADE COUNTY, FLORIDA  
 ROSENBERG GARDNER DESIGN  
 LANDSCAPE ARCHITECTURE  
 LAND PLANNING  
 MEMBER SOCIETY OF LANDSCAPE ARCHITECTS  
 HARDING AVENUE FROM 96TH ST TO 94TH ST  
 RENDERED PLANS  
 5-28-2013  
 AS NOTED  
 RENDERING



Harding Avenue Streetscape Improvements  
 SurfsideGreenway  
 Presentation



Stantec

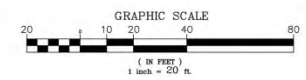
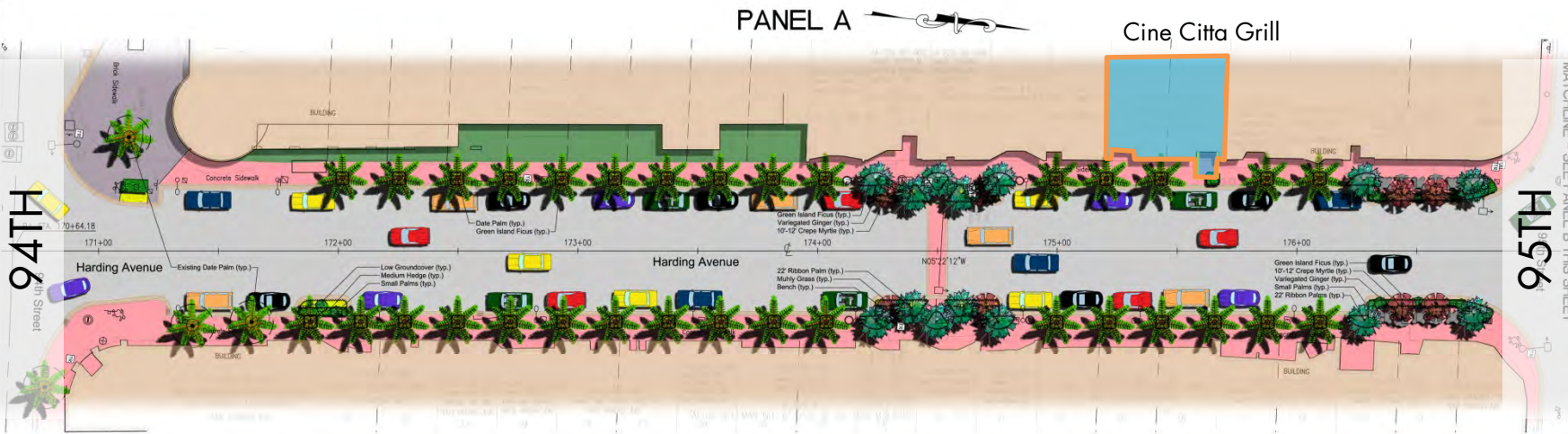

## HARDING AVE – CONFLICTS

(With Resolved Conflicts as per Luke-Sawgrass Landscape’s Recommendations)  
In Conflict with 1 New Date Palm – Total without 68 Date Palms

- Resolved Conflict
- Previous Conflict
- Updated Conflict

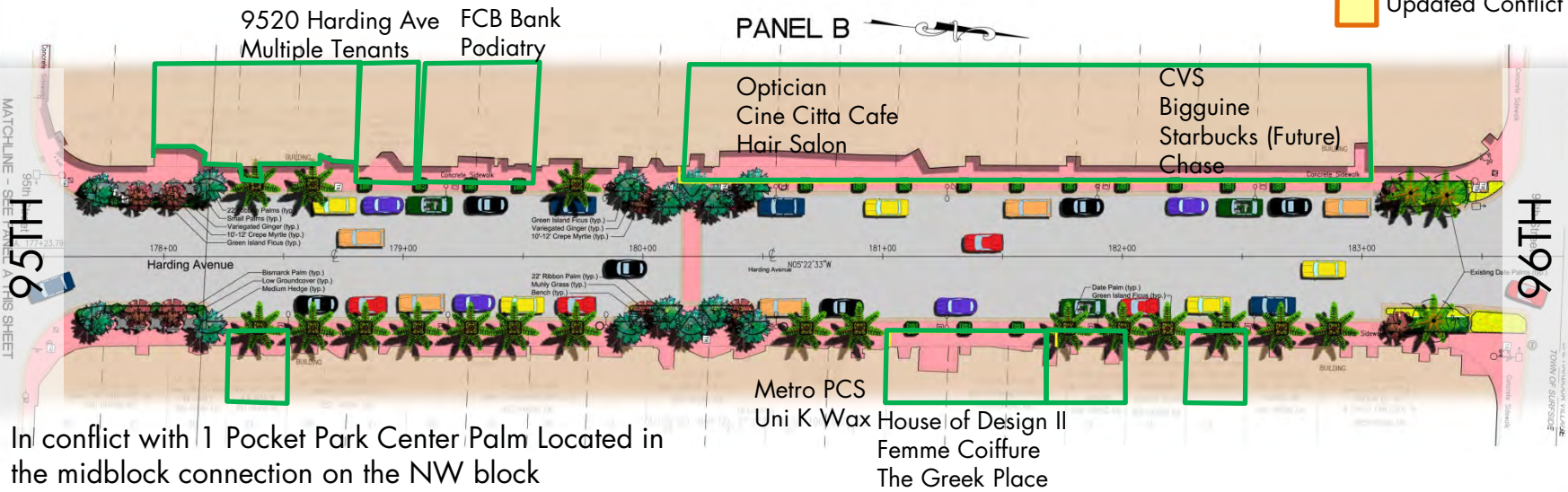

In conflict with 1 Pocket Park Center Palm Located in the midblock connection on the NW block

Metro PCS  
Uni K Wax House of Design II  
Femme Coiffure  
The Greek Place

95TH MATCHLINE - SEE PANEL B THIS SHEET  
 96TH MATCHLINE - SEE PANEL A THIS SHEET  
 TOWN OF SURFIDE, MIAMI-DADE COUNTY, FLORIDA  
 ROSENBERG GARDNER DESIGN  
 LANDSCAPE ARCHITECTURE  
 LAND PLANNING  
 MEMBER SOCIETY OF LANDSCAPE ARCHITECTS  
 HARDING AVENUE FROM 96TH ST TO 94TH ST  
 RENDERED PLANS  
 5-28-2013  
 AS NOTED  
 RENDERING



Harding Avenue Streetscape Improvements  
*SurfsideGreenway*  
 Presentation



**Stantec**

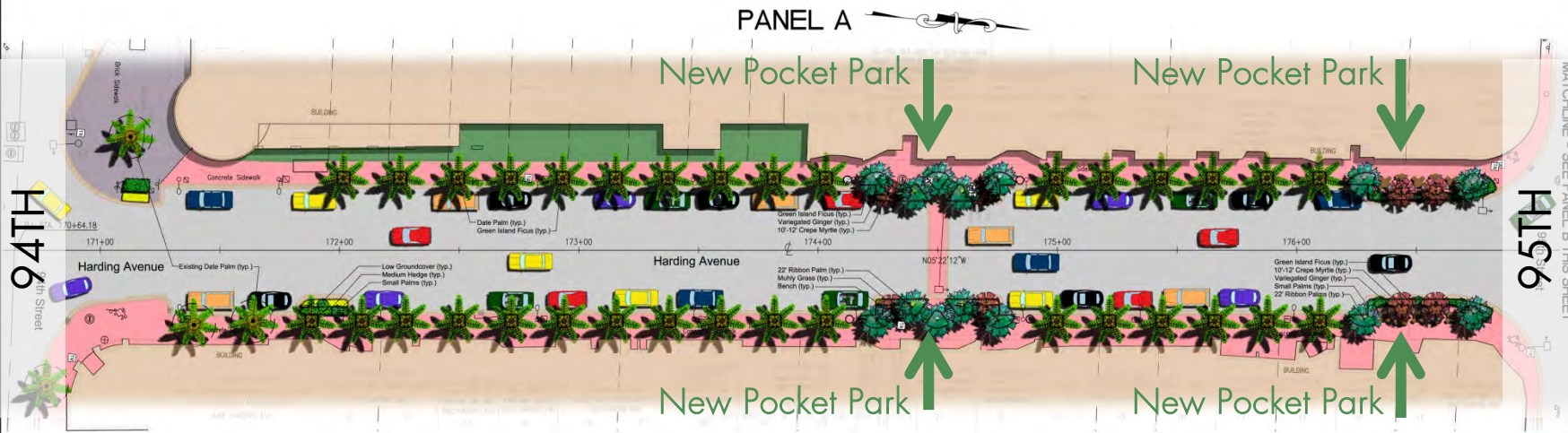

## HARDING AVE – PROPOSED

69 Main Date Palms (18 New Main Date Palms)  
 8 New Pocket Parks

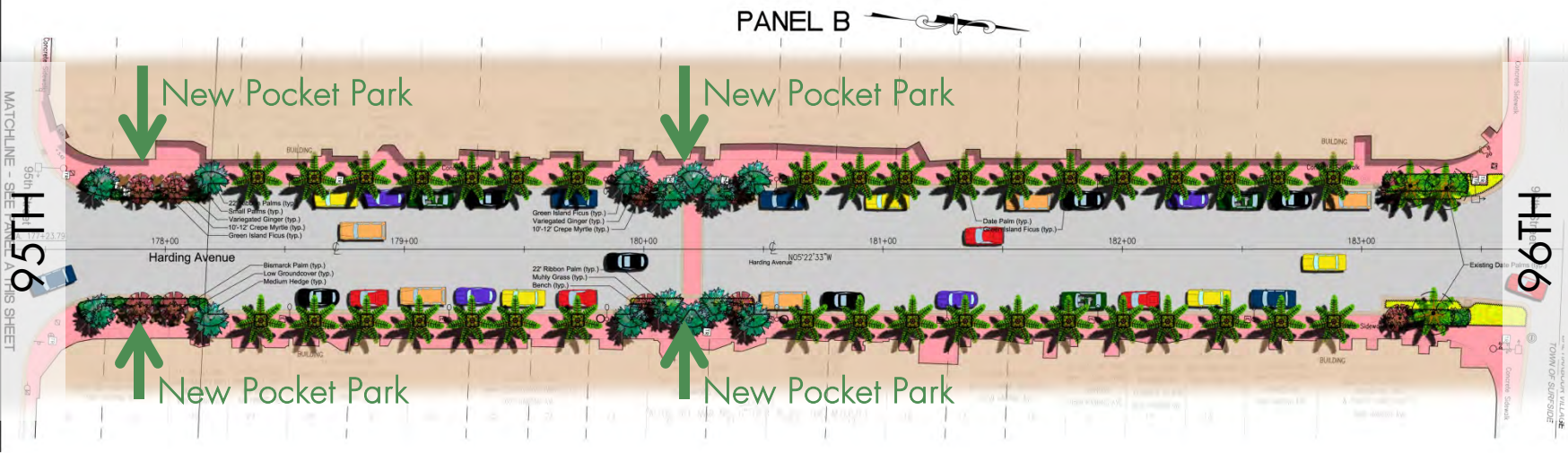
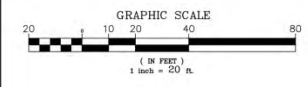

## Harding Avenue Streetscape Improvements

*SurfsideGreenway*  
 Presentation



4'-0" Minimum Pedestrian Zone

5'-0" width Pedestrian Zone Recommended

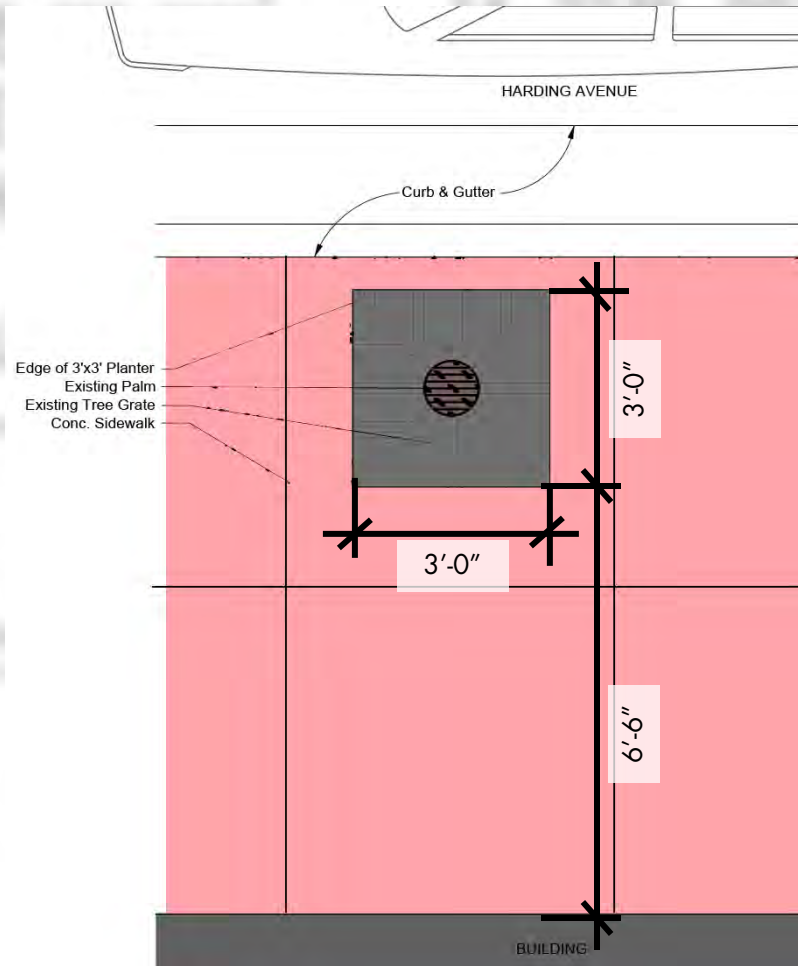

Existing Tree Planter Plan

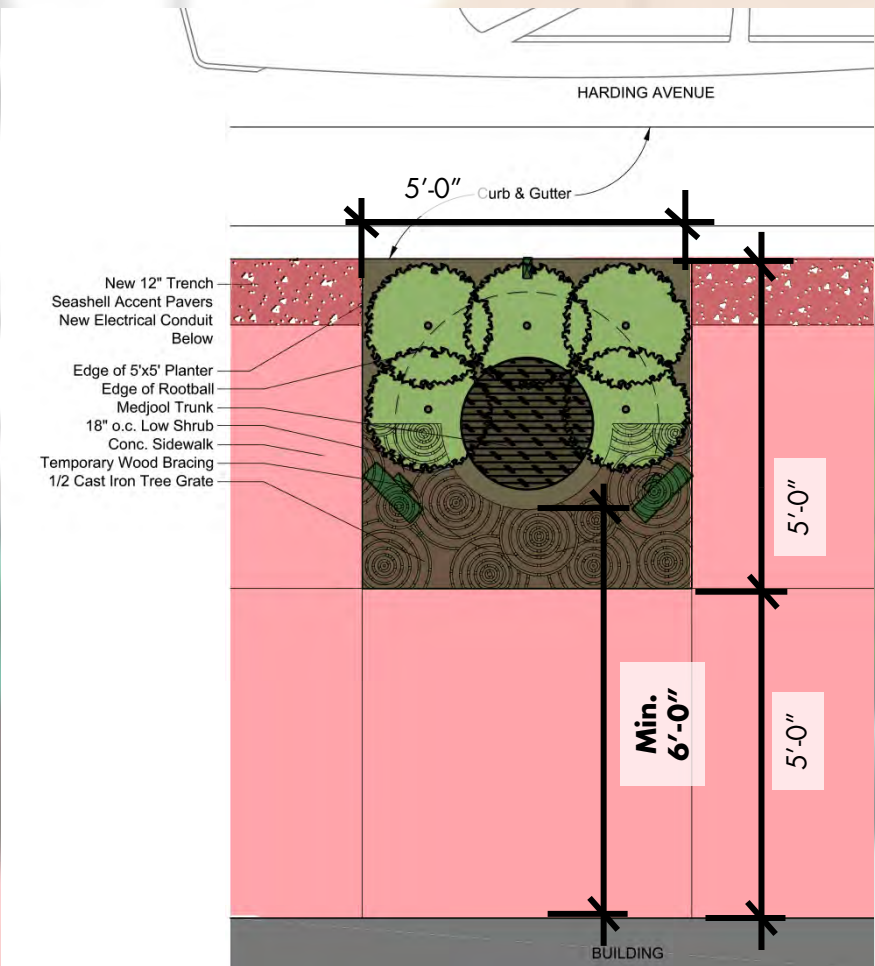

Proposed Tree Planter Plan

**Effective Clear Sidewalk Width at Planter Location**

Harding Avenue Streetscape Improvements

SurfsideGreenway

Presentation

ROSENBERG GARDNER DESIGN



Stantec







Existing Tree Planter Elevation

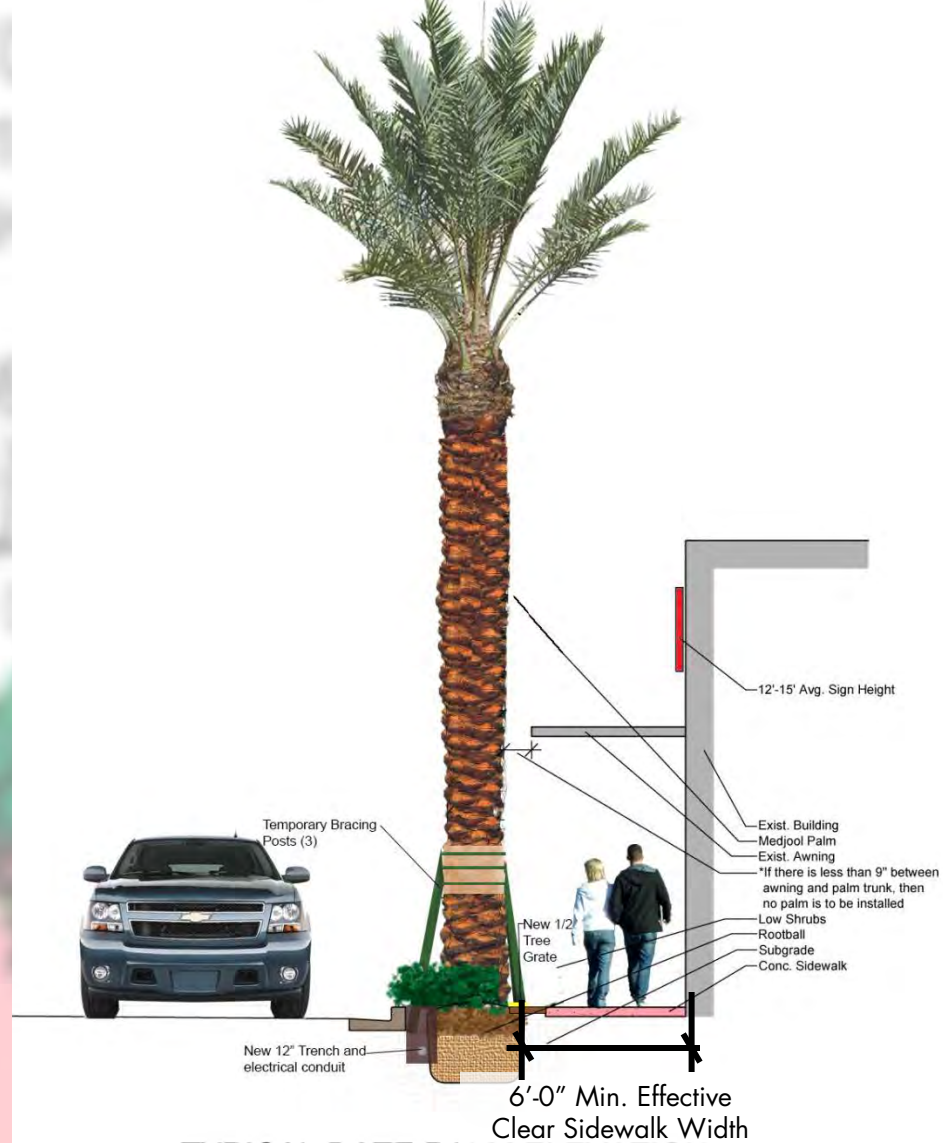

Proposed Tree Planter Elevation



As per the Accessible Public Rights of Way Planning and Design for Alterations by the Public Right of Way Access Advisory Committee  
 4'-0" Minimum Pedestrian Zone  
 5'-0" width Pedestrian Zone Recommended

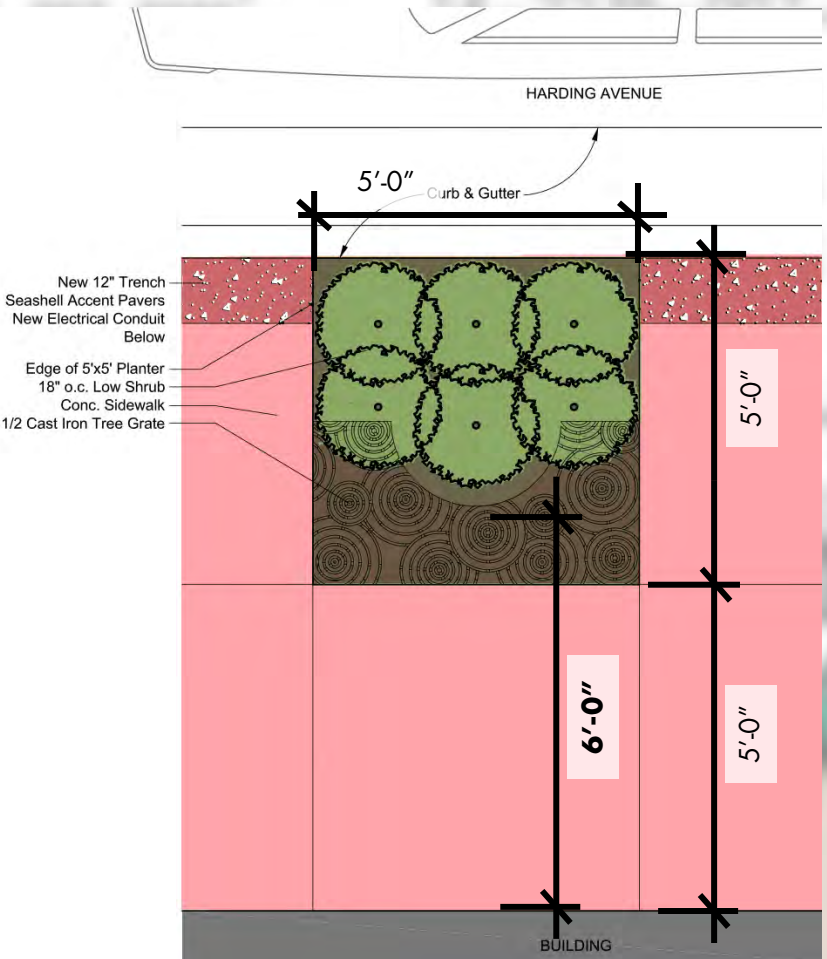

Proposed Planter at Conflicts Plan

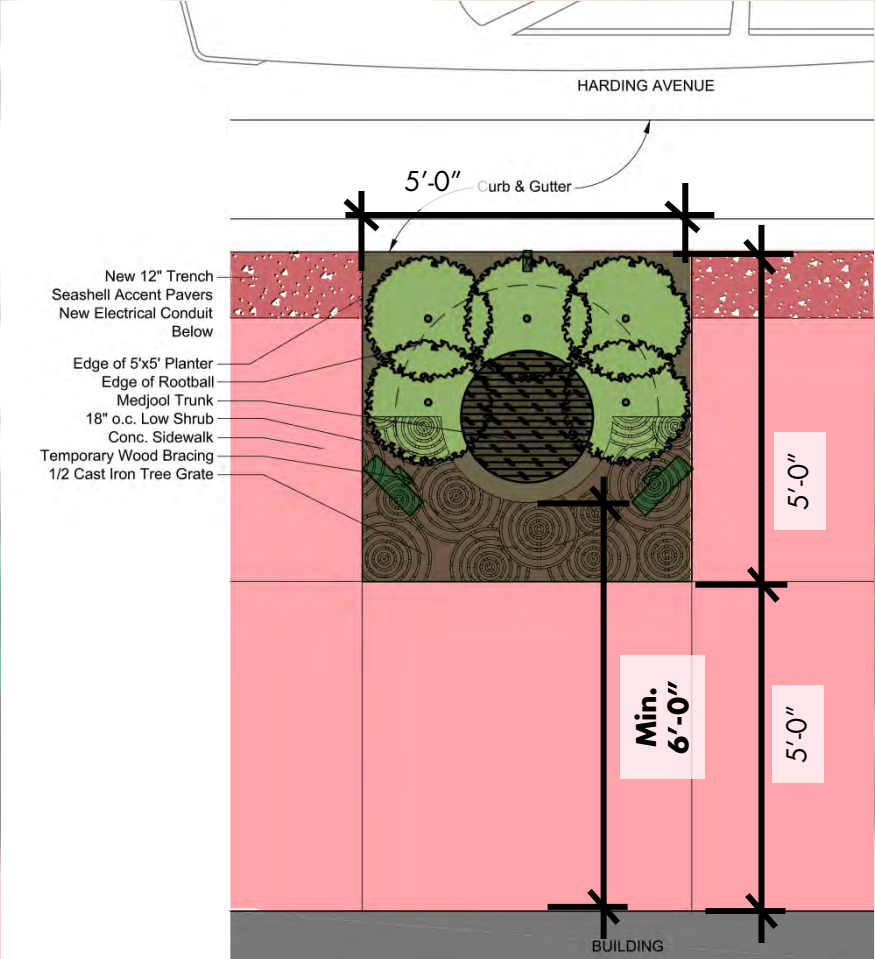

Proposed Tree Planter Plan



Harding Ave

Planters

Sidewalk

Buildings

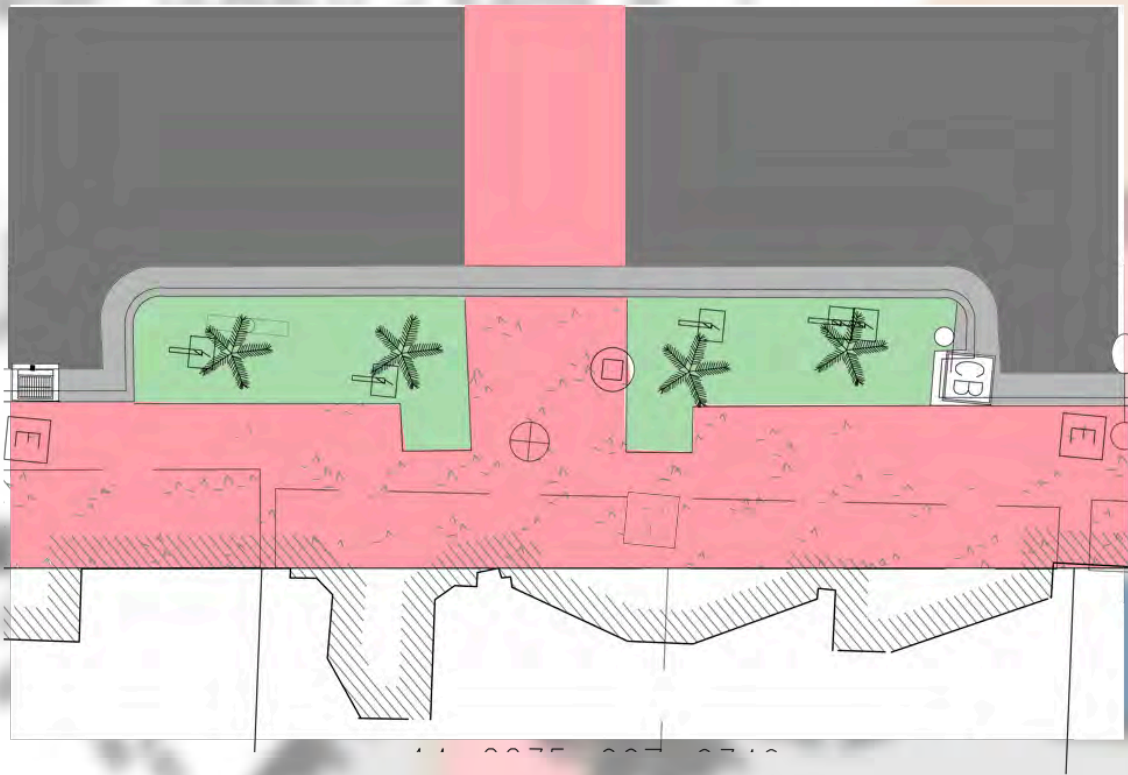

Existing Midblock Connection Plan



Harding Avenue Streetscape Improvements  
*SurfsideGreenway*  
 Presentation

ROSENBERG  
 GARDNER  
 DESIGN



Stantec

- TRASHCAN(TYP.)
- CREPE MYRTLE (TYP.)
- MUHLY GRASS (TYP.)
- VARIEGATED GINGER (TYP.)
- BISMARCK PALM (TYP.)
- GREEN ISLAND FICUS (TYP.)
- BENCH (TYP.)

Harding Avenue

- DATE PALM (TYP.)
- NEW 12" ELECTRICAL TRENCH WITH ACCENT PAVERS

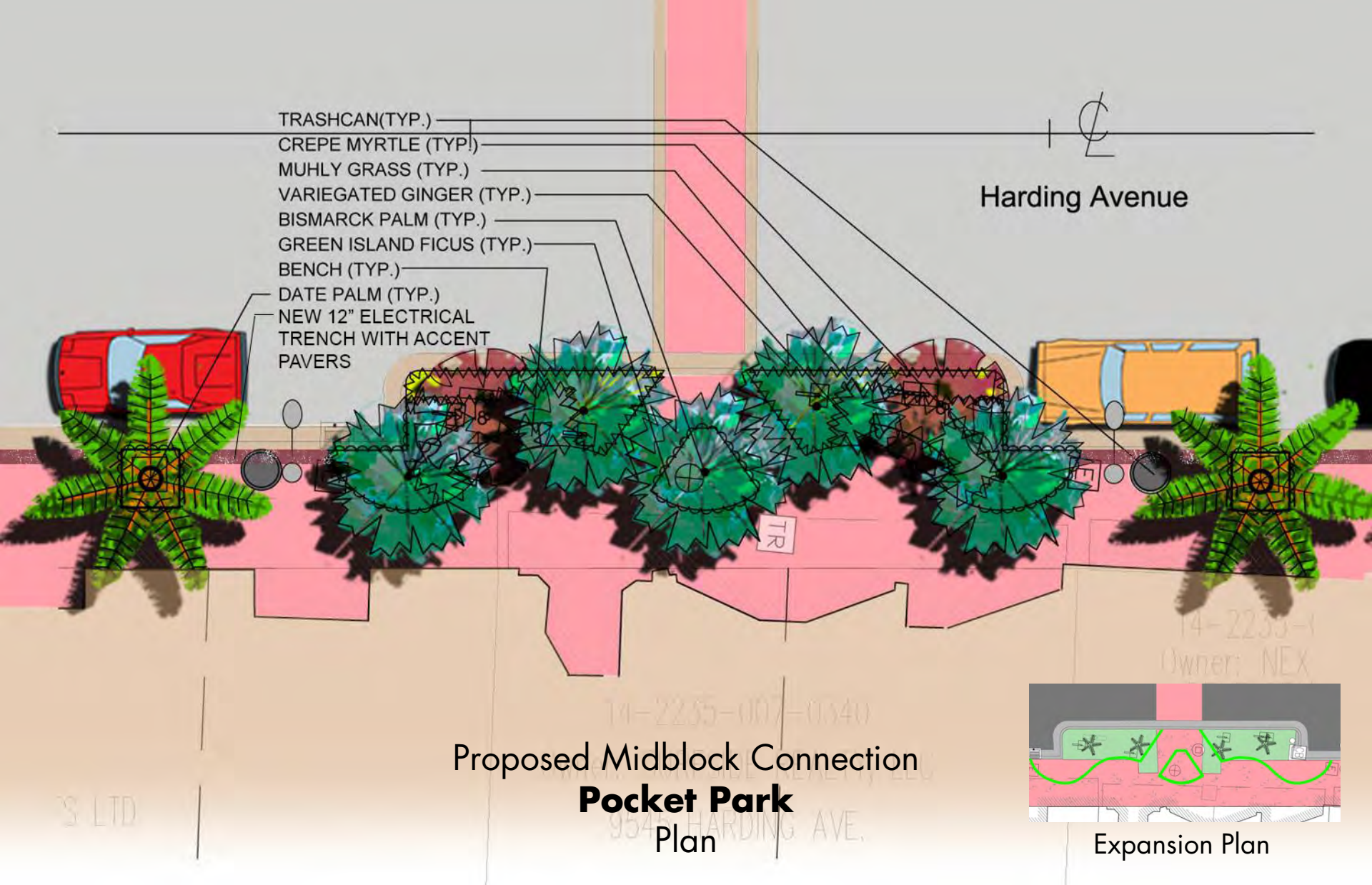

Proposed Midblock Connection  
**Pocket Park**  
 Plan

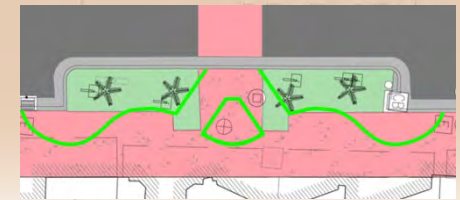

Expansion Plan



# Proposed Pocket Park Rendering

Street Furniture (benches, litter receptacles, and pavers shown are custom designed at an additional cost, not included in the cost estimate



Harding Avenue Streetscape Improvements  
*SurfsideGreenway*  
Presentation

ROSENBERG  
GARDNER  
DESIGN



**Stantec**

Probable Cost Estimate  
Original Scope of Work  
**Medjool Palms Main**

Overall Items	Cost	Remaining
<b>Total Project Budget</b>	<b>\$650,000.00</b>	<b>\$650,000.00</b>
Professional Fees	\$57,500.00	\$592,500.00
Contingency (10%)	\$59,250.00	\$533,250.00

Project Line Items	Quantity	Cost (Each)	Total Cost	Remaining Cont.
Relocation of existing trees. To a site elsewhere in the City (By Supplier)	75	\$0.00	\$0.00	\$533,250.00
Reconfiguration of existing irrigation system (Dripper Pipe System)	1	\$25,000.00	\$25,000.00	\$508,250.00
Expansion of planting pits (From 3'x3' to 5'x5')	69	\$150.00	\$10,350.00	\$497,900.00
Medjool Palms (Main Tree)	69	\$5,250.00	\$362,250.00	\$135,650.00
Up Lighting for palm trees (LED, 2 per palm, +receptacle)	138	\$750.00	\$103,500.00	\$32,150.00
<b>Contingency Adjusted</b>				
<b>0% Contingency Remaining</b>			<b>\$59,250.00</b>	<b>\$91,400.00</b>
General Planting (shrubs, accent palms, etc.)	1	\$65,000.00	\$65,000.00	\$26,400.00
"Pocket Parks" (including cutting, patching, and new concrete)	8	\$2,000.00	\$16,000.00	\$10,400.00
Trenching of sidewalk 12" for new electrical raceway, including pavers	1700	\$47.00	\$79,900.00	-\$69,500.00
FPL connection to new conduit, including directional boring under Harding Avenue and 95th Street	1	\$38,000.00	\$38,000.00	-\$107,500.00
1/2 Tree Grates and frames	69	\$750.00	\$51,750.00	-\$159,250.00
Benches for Pocket Parks (two per park) Basic line	8	\$1,310.00	\$10,480.00	-\$169,730.00
Trash Cans Basic line	12	\$1,230.00	\$14,760.00	-\$184,490.00
Recycle Cans Basic line	4	\$1,320.00	\$5,280.00	-\$189,770.00
<b>SUB TOTAL:</b>			<b>\$782,270.00</b>	
<b>Total Costs + Professional Fees (\$57,500)</b>			<b>\$839,770.00</b>	<b>-\$189,770.00</b>

Estimate of Probable Cost prepared by Rosenberg Gardner Design



Accent Trees



Main Tree



Standard Bench



Standard Litter and Recycle

Street Furniture shown based off original recommendation from study by others last year

Harding Avenue Streetscape Improvements  
*SurfsideGreenway*  
Presentation

ROSENBERG  
GARDNER  
DESIGN



Stantec





95th

Midblock

96th



Harding Avenue – Existing Elevation



Harding Avenue Streetscape Improvements  
SurfsideGreenway  
Presentation

ROSENBERG  
GARDNER  
DESIGN



Stantec



95th

Midblock

96th



Harding Avenue – Proposed Date Palms  
Original Scope of Work



Harding Avenue Streetscape Improvements  
*SurfsideGreenway*  
Presentation

ROSENBERG  
GARDNER  
DESIGN



Stantec





95th

Midblock

96th



Harding Avenue – Proposed Date Palms  
With Temporary Bracing  
Original Scope of Work



Harding Avenue Streetscape Improvements  
*SurfsideGreenway*  
Presentation

ROSENBERG  
GARDNER  
DESIGN



Stantec



Thank you

SurfsideGreenway

Harding Avenue Streetscape Improvements  
SurfsideGreenway  
Presentation

ROSENBERG  
GARDNER  
DESIGN



Stantec

